

**NOTE**

CONTOURS AND OTHER TOPOGRAPHIC FEATURES ARE COMPILED FROM AERIAL MAPPING BY HENRY COUNTY AND AERIAL MAPPING AND CONTOURS BY "EARTH DATA INTERNATIONAL". THE CONTOUR INTERVAL IS TWO FEET. TEN FOOT INTERVAL IS SHOWN FOR CLARITY.

**VIRGINIA UNIFORM CODING SYSTEM**  
REFERENCE VIRGINIA EROSION AND SEDIMENT CONTROL HANDBOOK

NO.	TITLE	KEY	SYMBOL
3.02	TEMPORARY STONE CONSTRUCTION ENTRANCE	CE	
3.03	CONSTRUCTION ROAD STABILIZATION	STB	
3.04	STRAW BALE BARRIER	CRS	
3.05	SILT FENCE	SF	
3.07	STORM DRAIN INLET PROTECTION	IP	
3.08	CULVERT INLET PROTECTION	CIP	
3.09	TEMPORARY DIVERSION DIKE	DD	
3.10	TEMPORARY FILL DIVERSION	FD	
3.11	TEMPORARY ROW DIVERSION	RWD	
3.12	DIVERSION	DV	
3.13	TEMPORARY SEDIMENT TRAP	ST	
3.14	TEMPORARY SEDIMENT BASIN	SD	
3.15	TEMPORARY SLOPE DRAIN	TSD	
3.16	PAVED FLUME	PF	
3.17	STORM WATER CONVEYANCE CHANNEL	SCC	
3.18	OUTLET PROTECTION	OP	
3.19	RIPRAP	RR	
3.20	ROCK CHECK DAMS	CD	
3.28	SUBSURFACE DRAIN	SD	
3.29	SURFACE ROUGHENING	SR	
3.30	TOPSOILING	TO	
3.31	TEMPORARY SEEDING	TS	
3.32	PERMANENT SEEDING	PS	
3.35	MULCHING	M	
3.36	SOIL STABILIZATION BLANKETS AND MATTING	B/M	
3.38	TREE PRESERVATION AND PROTECTION	TP	
3.39	DUST CONTROL	DC	

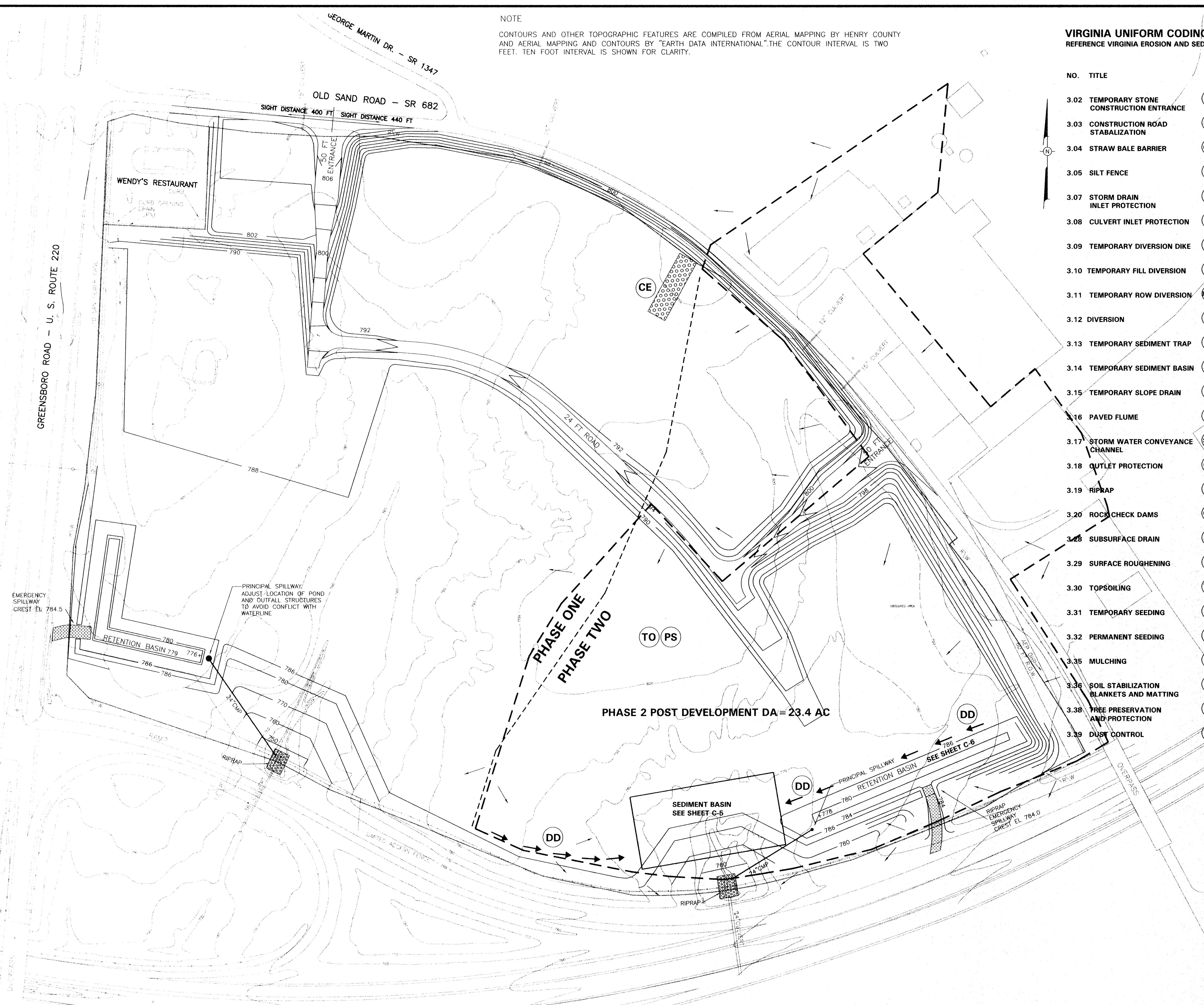

MASS GRADING AND UTILITIES PLANS FOR  
**PHASE TWO**  
**SHEFFIELD ESTATES, INC.**  
RIDGEWAY DISTRICT, HENRY COUNTY, VIRGINIA

PREPARED FOR  
**SHEFFIELD ESTATES, INC.**  
C/O J & R MANAGEMENT  
PO BOX 952  
MARTINSVILLE, VIRGINIA 24112  
PHONE 540-632-5325

PREPARED BY  
**PIEDMONT LAND SURVEYING, LLC**  
3416 VIRGINIA AVENUE SUITE 4  
COLLINSVILLE, VIRGINIA 24078  
PHONE 540-647-4448 FAX 540-647-4252

DATE	DESCRIPTION
8-31-00	REVIEW

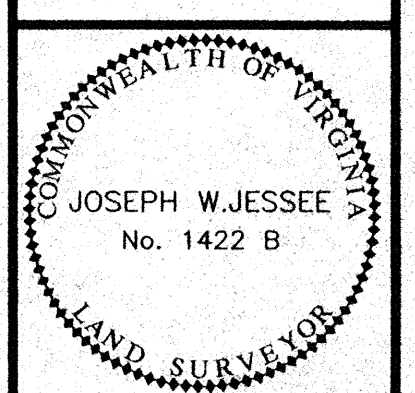

JOB NO. 00-175

**E & S  
PLAN**

**C-3**